

TVILIGHT



English

SkyLite V3.1 External

Installation Manual

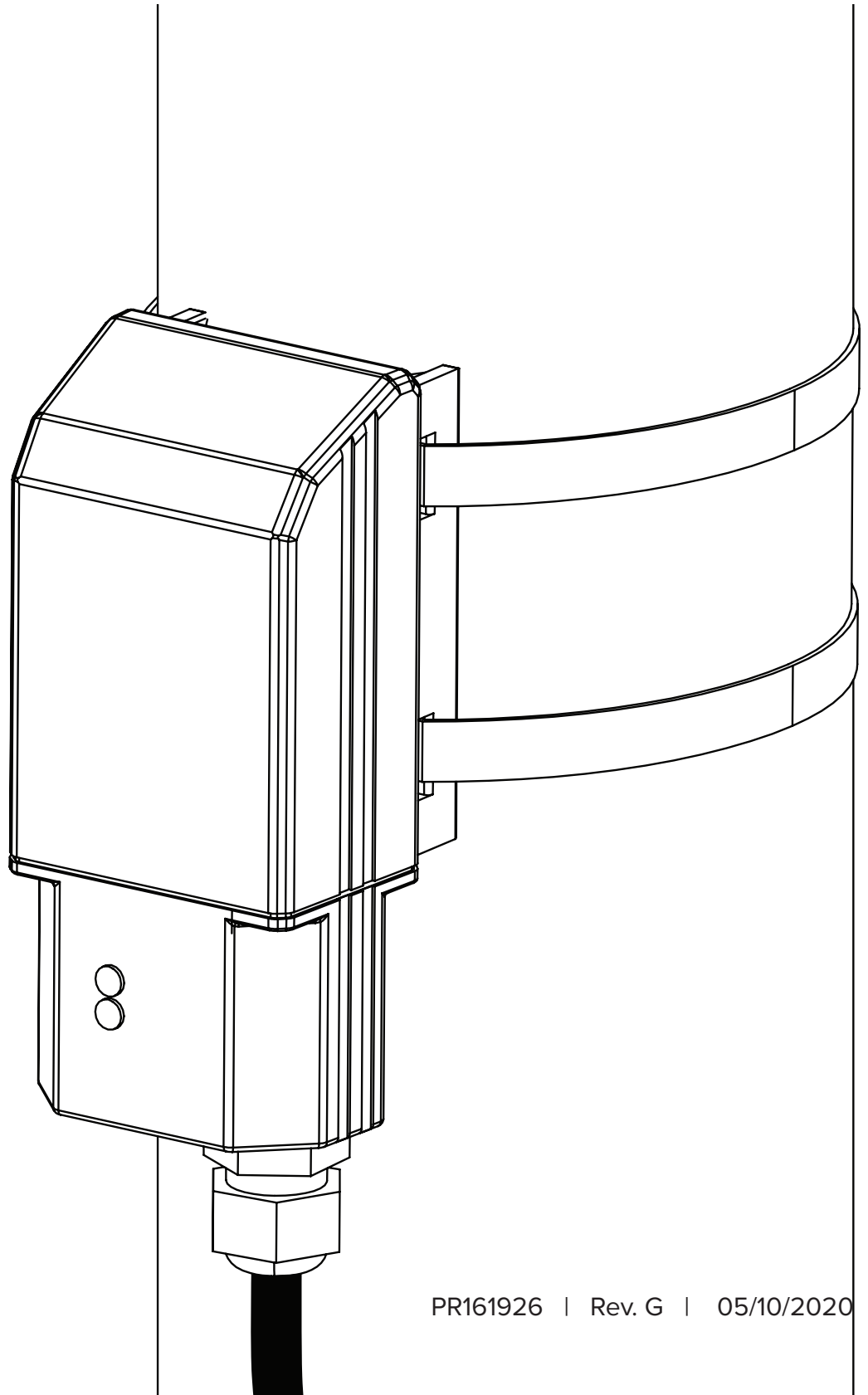



ATTENTION:

- ☐ In order to function properly, SkyLite v3.1 **must** be connected to a dimmable driver/ballast.

NOTE: Some dimmable drivers/ballasts **must** be programmed/set to dimmable mode. If this has not been done, SkyLite v3.1 will not be able to dim the connected luminaire.

In box:

SkyLite V3.1

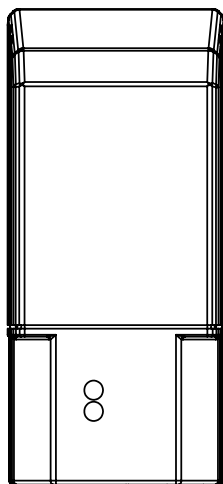

Pole ID Label



M16 Cable Gland

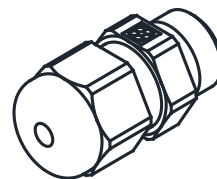

OR

16 mm Grommet

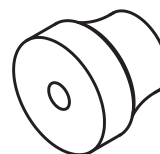

5.5m Cable

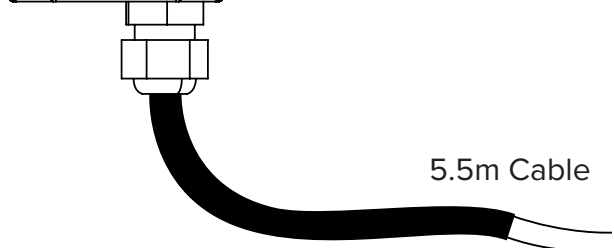

You'll need:

Drill

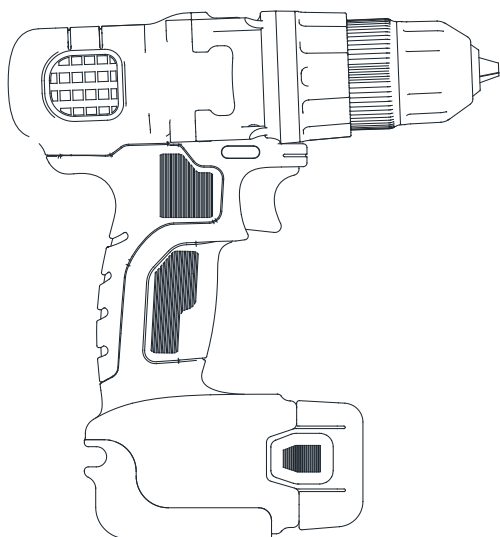

Generic Strap x 2

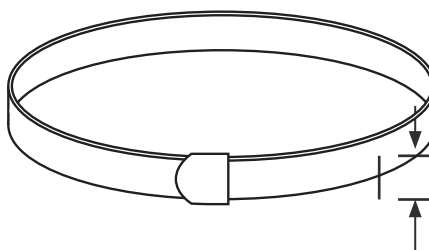

Max = 11mm
Min = 8mm

Scan&Go App

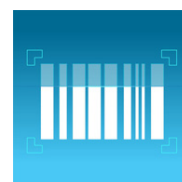

Available in the
Apple App Store
and in the
Google Play Store

Wago x 2

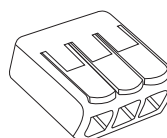

M16 Threaded
OR
16 mm



1. Push Cable Gland/Grommet over the cable and UV Protective Sleeve

Note: Leave some UV Sleeve in the Cable Gland/Grommet.

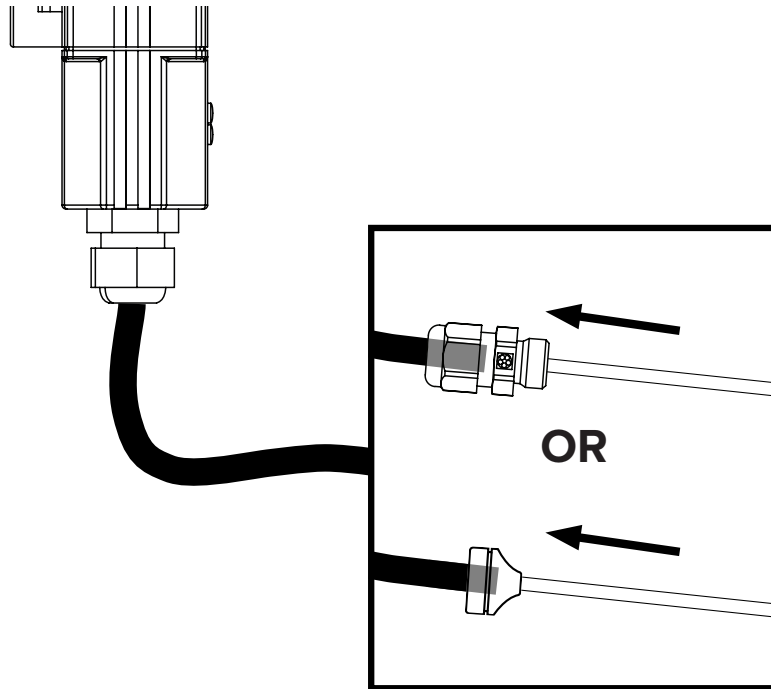

2. Drill hole into the pole: - M16 threaded (Cable Gland) OR - 16 mm (Grommet)

Note: For added protection against rust, the use of an anti-corrosion spray such as WD40 Corrosion inhibitor or equal is recommended.

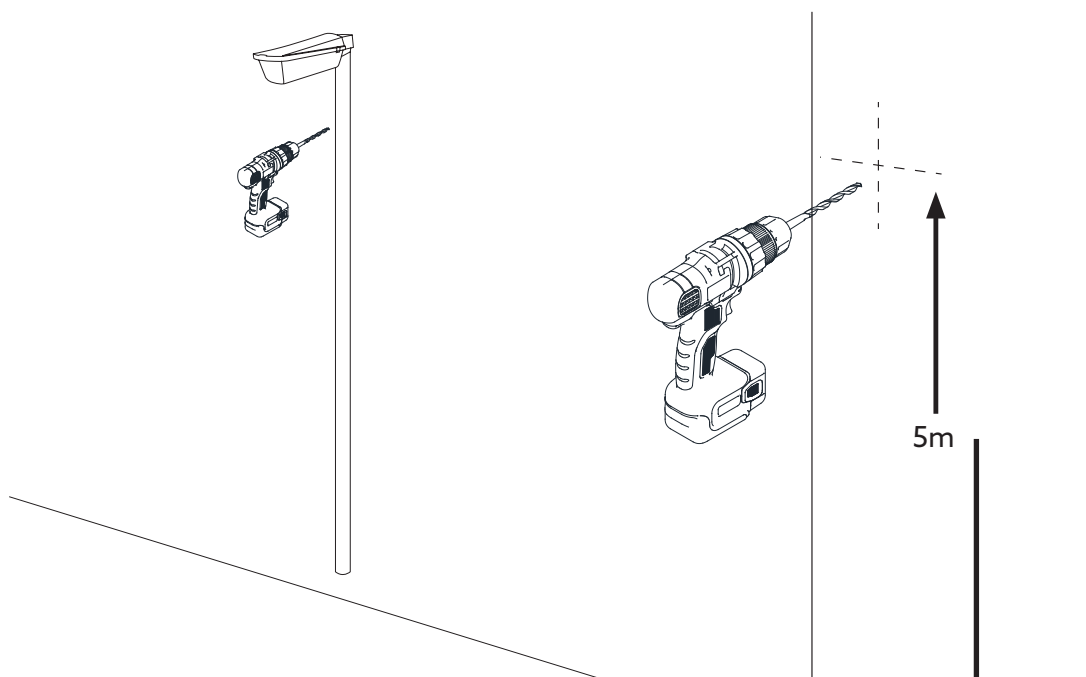

3. Run wire into hole in the pole

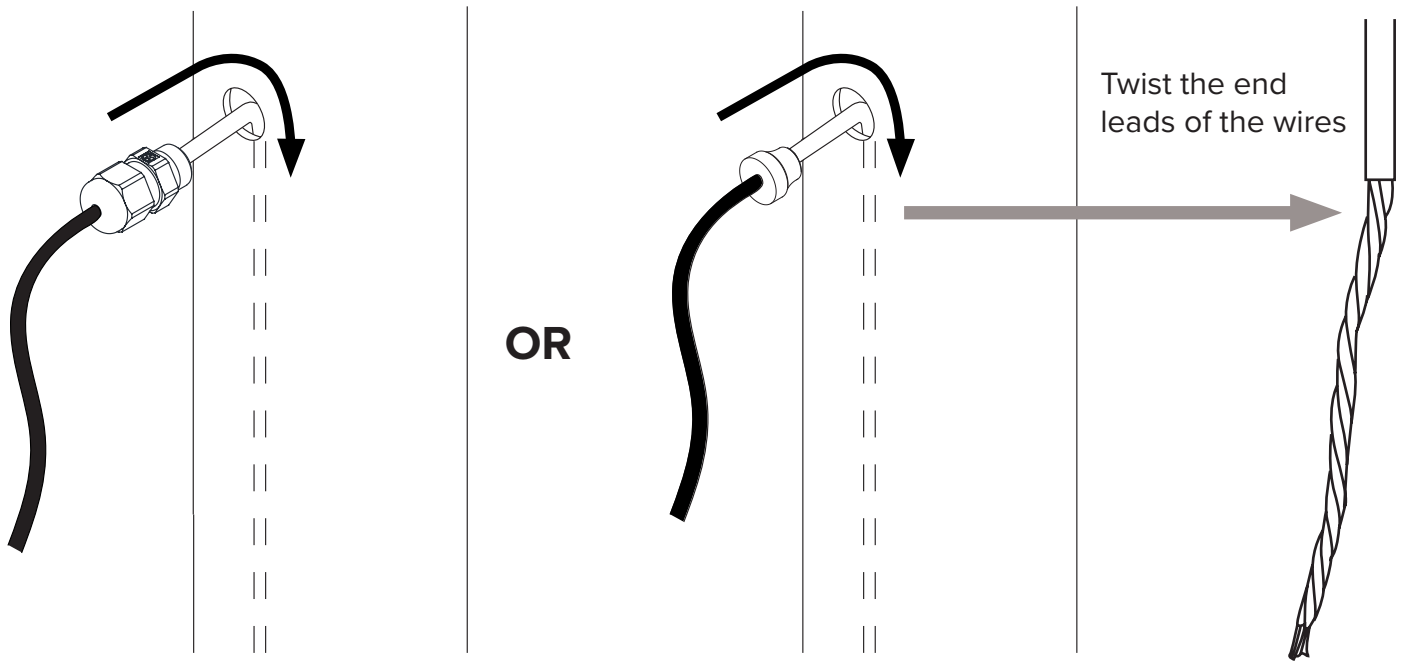

4. Insert Cable Gland/Grommet into hole in the pole

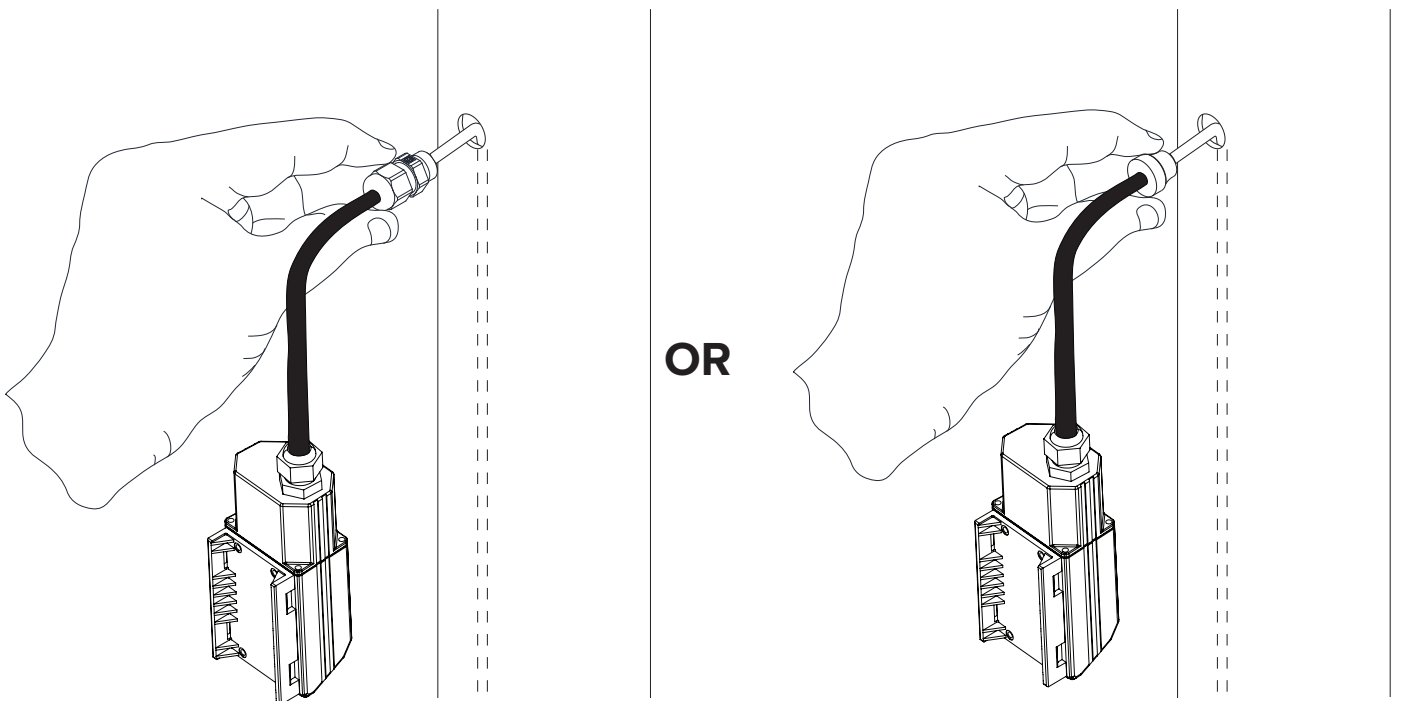

5. Screw Cable Gland OR press Grommet into the pole

NOTE: Make sure the UV Protective Sleeve is inside the Cable Gland/Grommet when tightening.

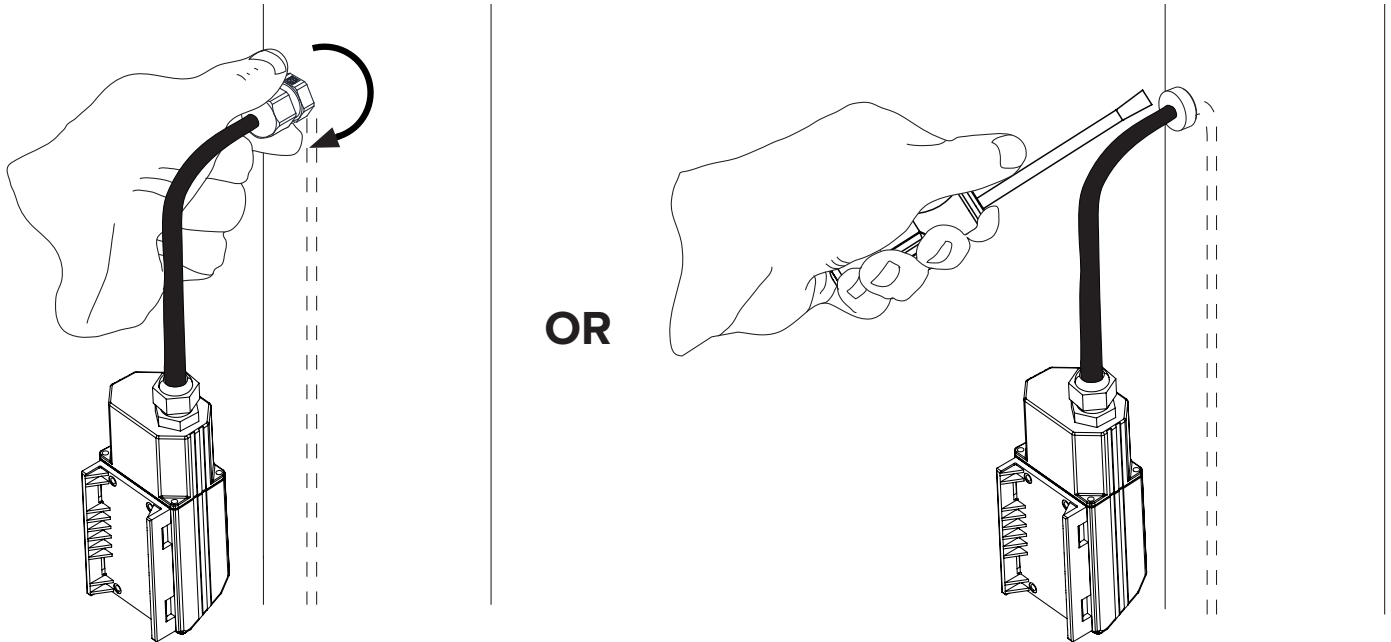

6. Strap product to the pole

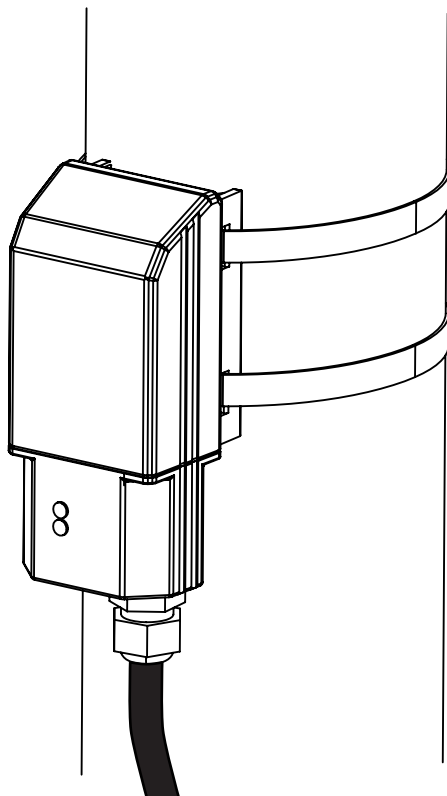

Tensioning Tool

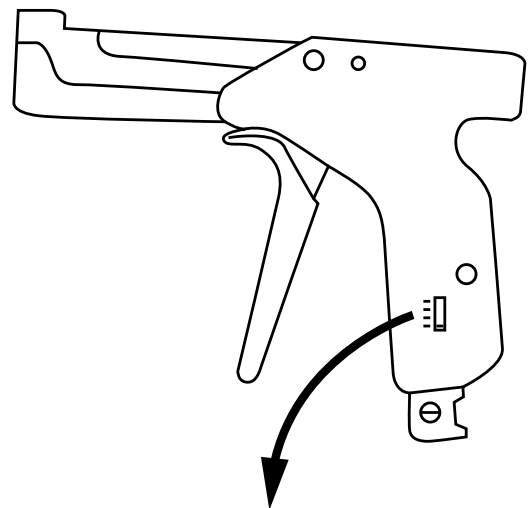

* Ensure Tensioning Tool is set to maximum tension (#4)

7. Apply Pole ID Label to the pole

Ensure that the Product and Pole ID Labels match.

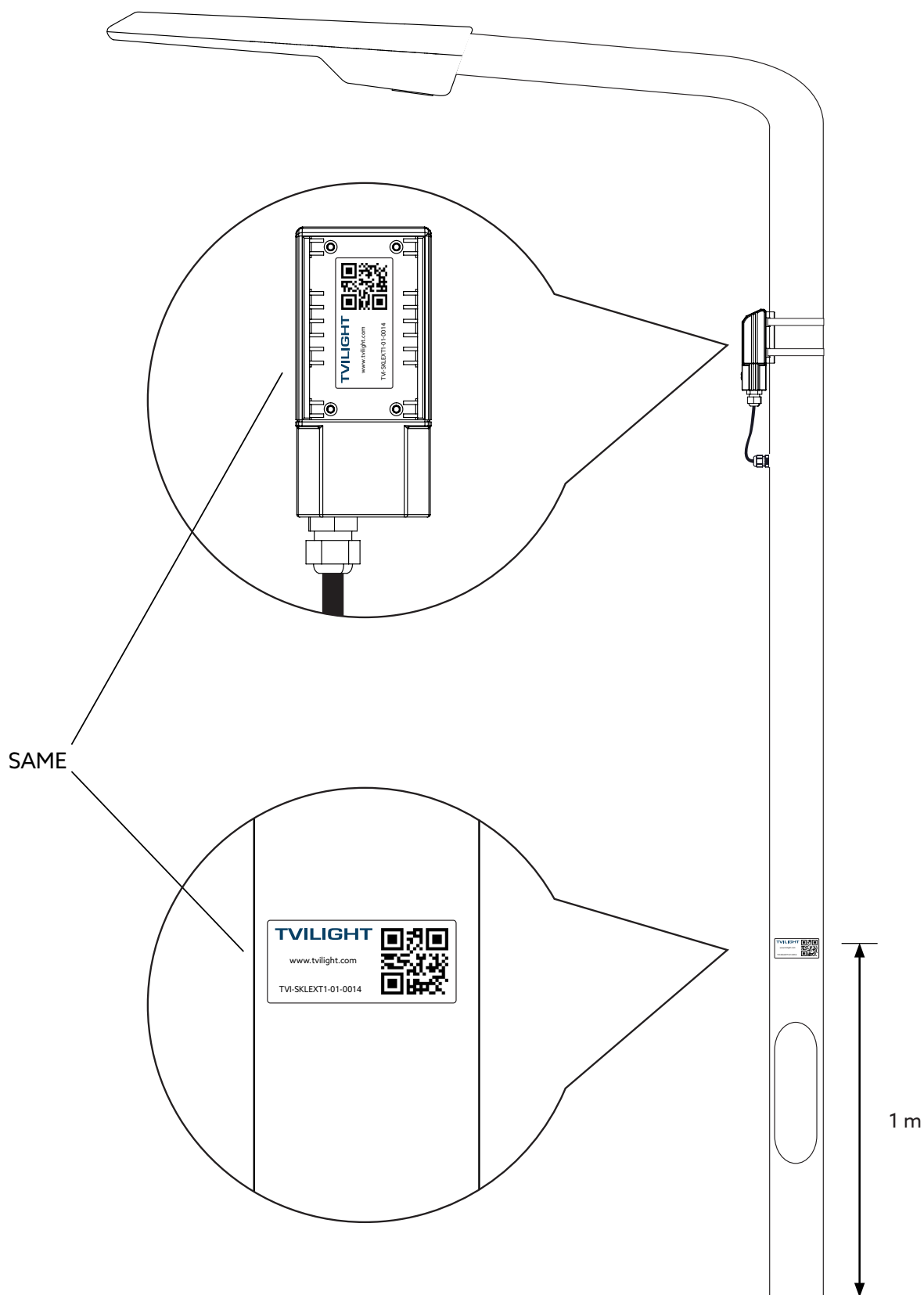

8. Add device to CityManager

1. Download Tvilight Scan&Go from Apple iOS App Store or from Google Play Store.

2. Login with your Username and Password.

3. Use the 'Add device' function in Scan&Go app to add the device to CityManager.

4. The location of the new device is determined by Scan&Go's GPS and it will be indicated on the map.

5. The Device Serial Number will be added when scanning the QR-Code with the camera.

6. Fill in the required fields (the ones with an asterisk), select the device type and also **select the type of ballast** (PWM or DALI-Logarithmic or DALI-Linear).

Note: The type of ballast must be known before installation.

7. Press save and move to next device.

For more information on how to use Scan&Go app, please visit:
<https://www.tvilight.com/scan-go/>

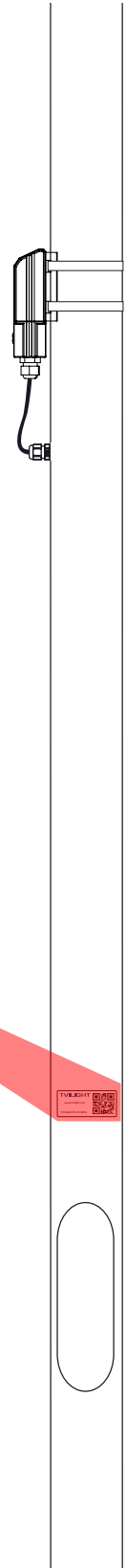

Wiring Diagram

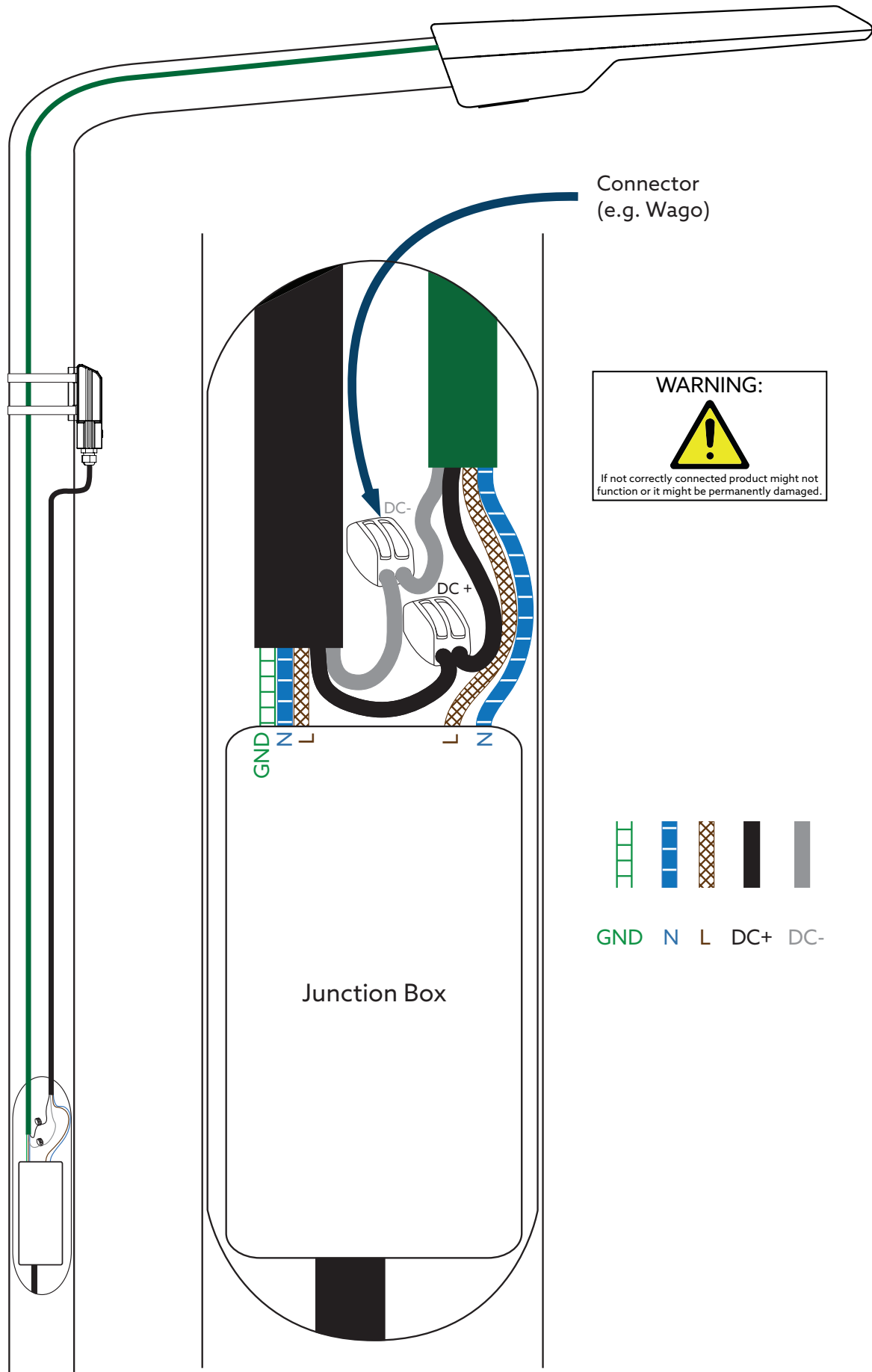

Wiring Diagram

To Armature

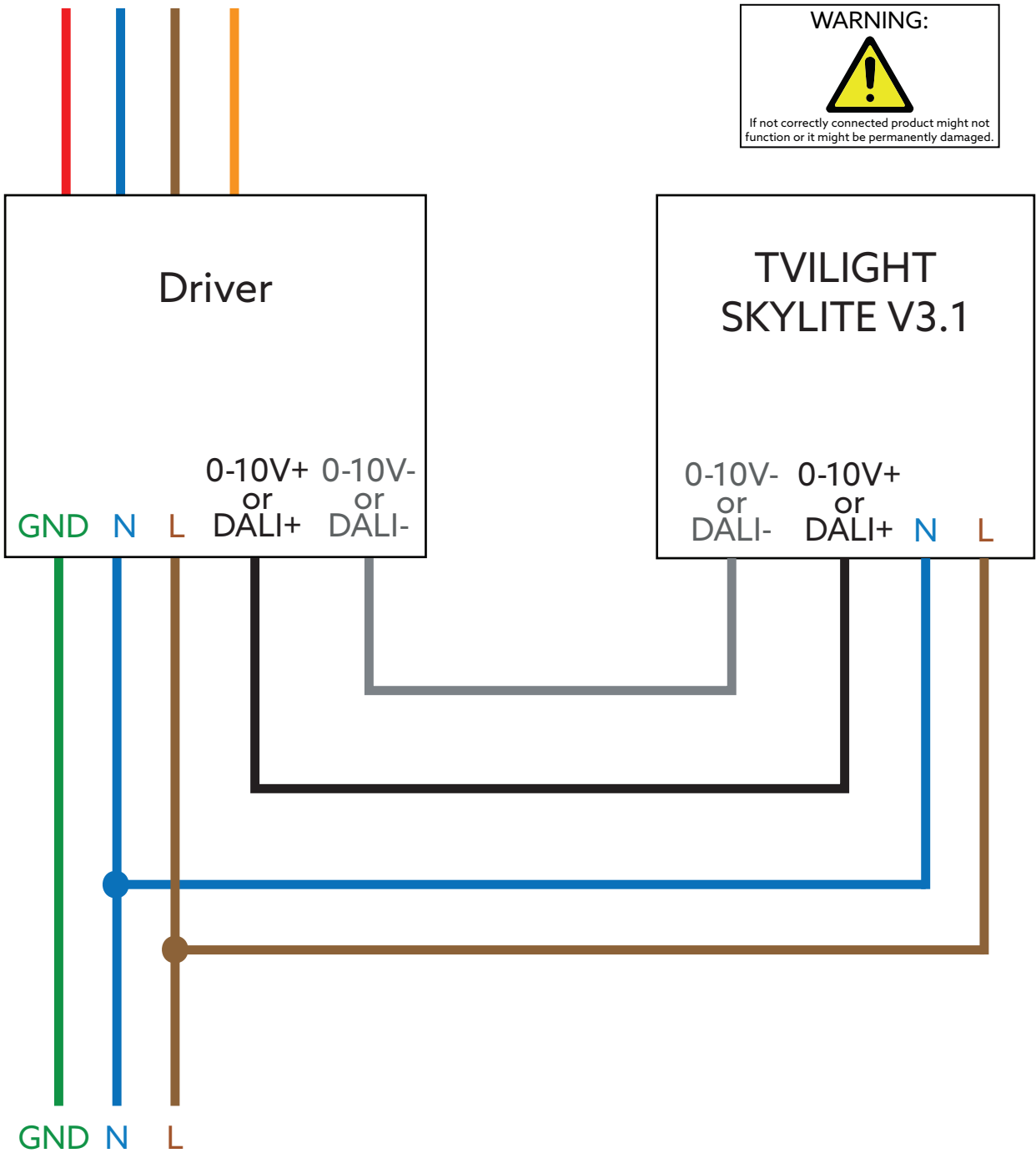

WARNING:

If not correctly connected product might not function or it might be permanently damaged.

To Mains

GND	N	L	0-10V+ or DALI+	0-10V- or DALI-
				
GREEN	BLUE	BROWN	BLACK	GREY

Note: For added protection, an external circuit breaker at the power input of the product is recommended. Circuit breakers such as the ELeQ LS-94 5L2408 or similar rated products are acceptable.