

TVILIGHT



English

CitySense Plus

Installation Manual

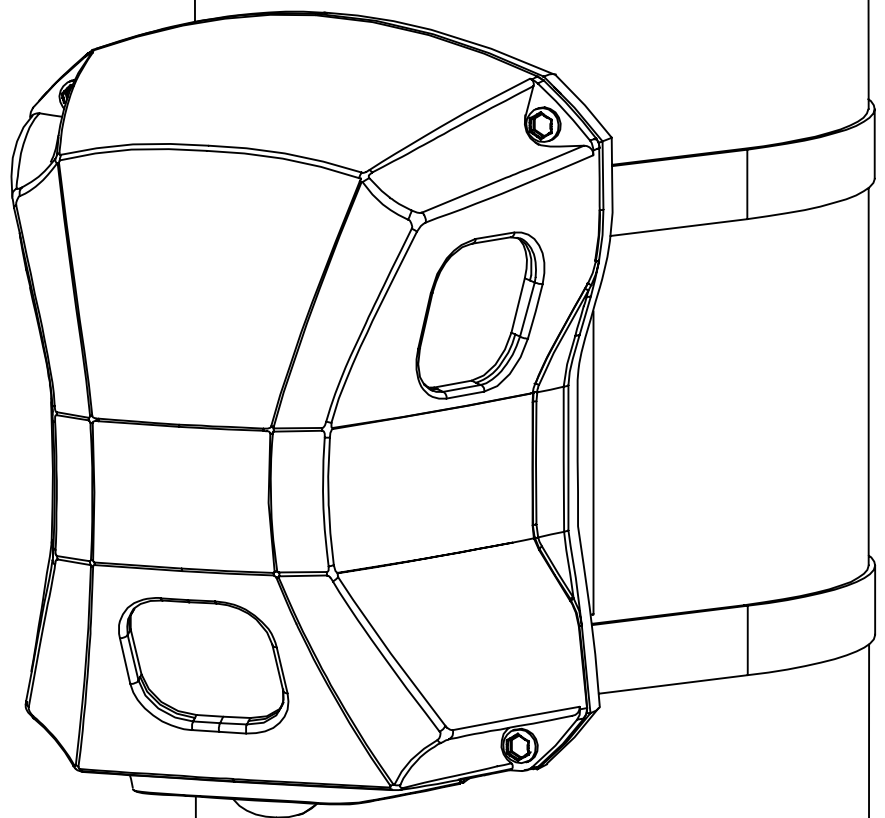



ATTENTION:



In order to function properly, CitySense Plus must be connected to a dimmable driver/ballast.

NOTE: Some dimmable drivers/ballasts must be programmed/set to dimmable mode. If this has not been done, CitySense Plus will not be able to dim the connected armature.

In box:

CitySense Plus

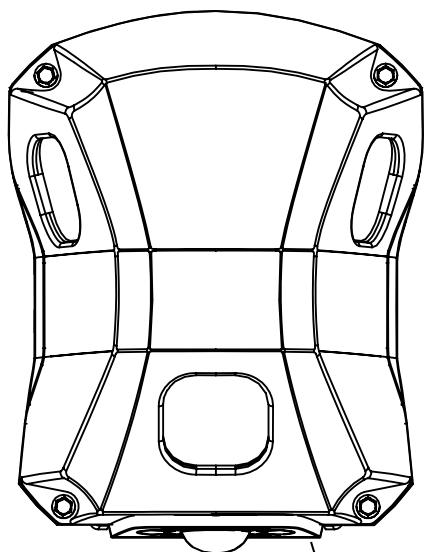

Sticker



M16 Cable Gland

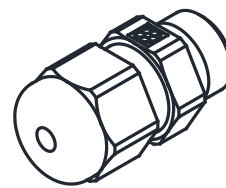

OR

20 mm Rubber Grommet

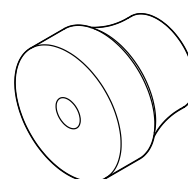

5m Cable

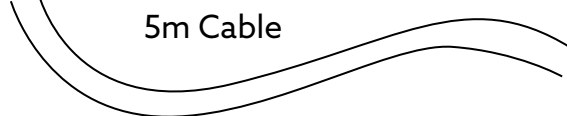

You'll need:

Drill

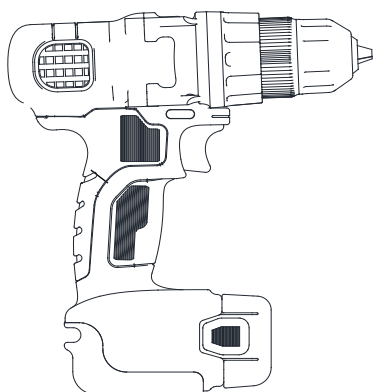

Generic Strap x 2

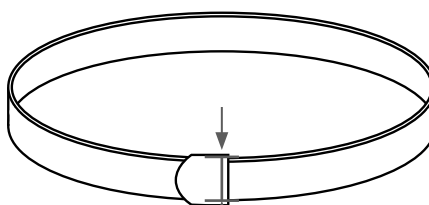

Max = 11mm
Min = 8mm

Scan&Go App



Available in the
Apple App Store
and in the
Google Play Store

M16 Thread



Wago x 4

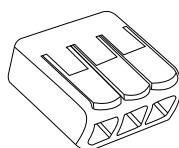

1. Run wire through Cable Gland/Grommet

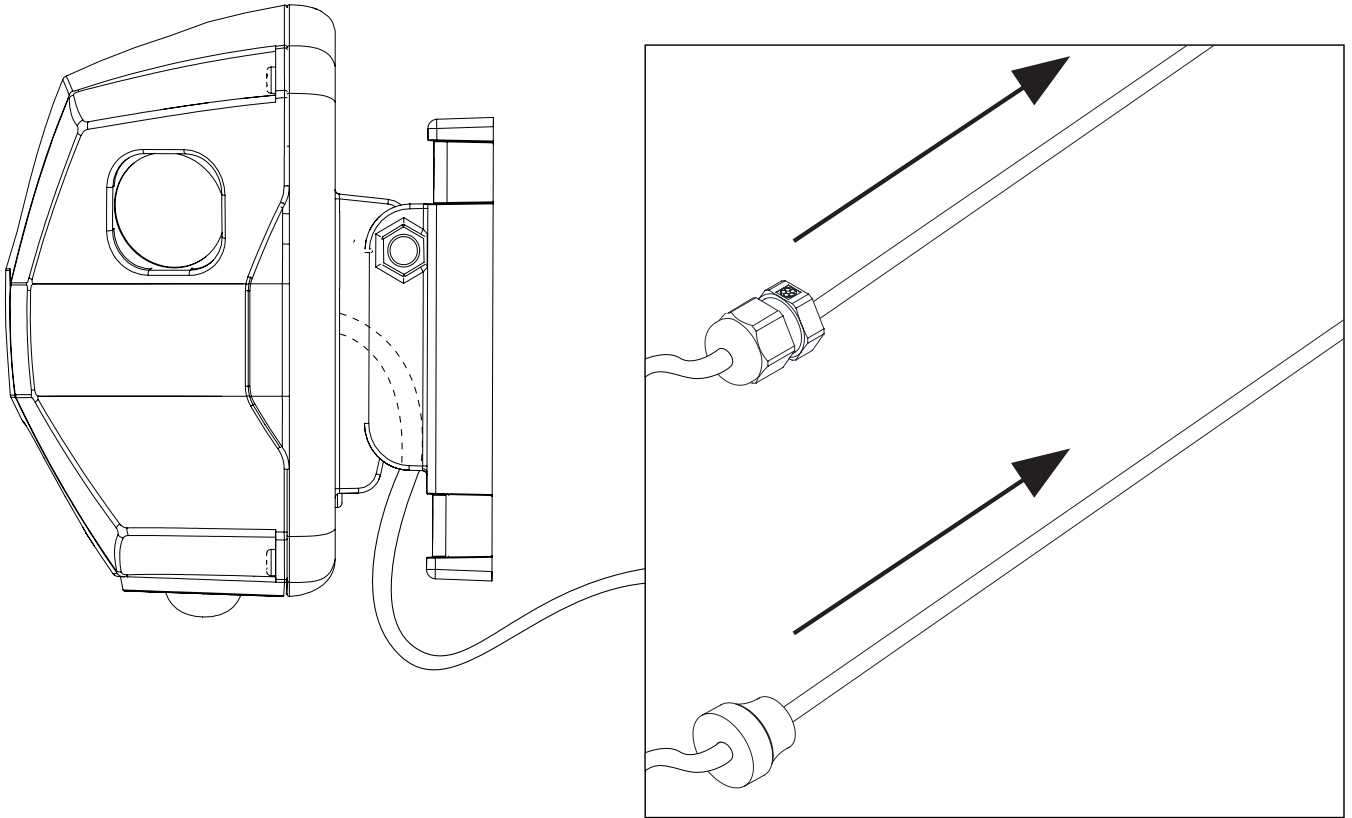

2. Drill hole into the pole:

- M16 threaded (Cable Gland) OR
- 20 mm (Grommet)

Note: for added protection against rust, the use of an anti-corrosion spray such as WD40 Corrosion inhibitor or equal is recommended.

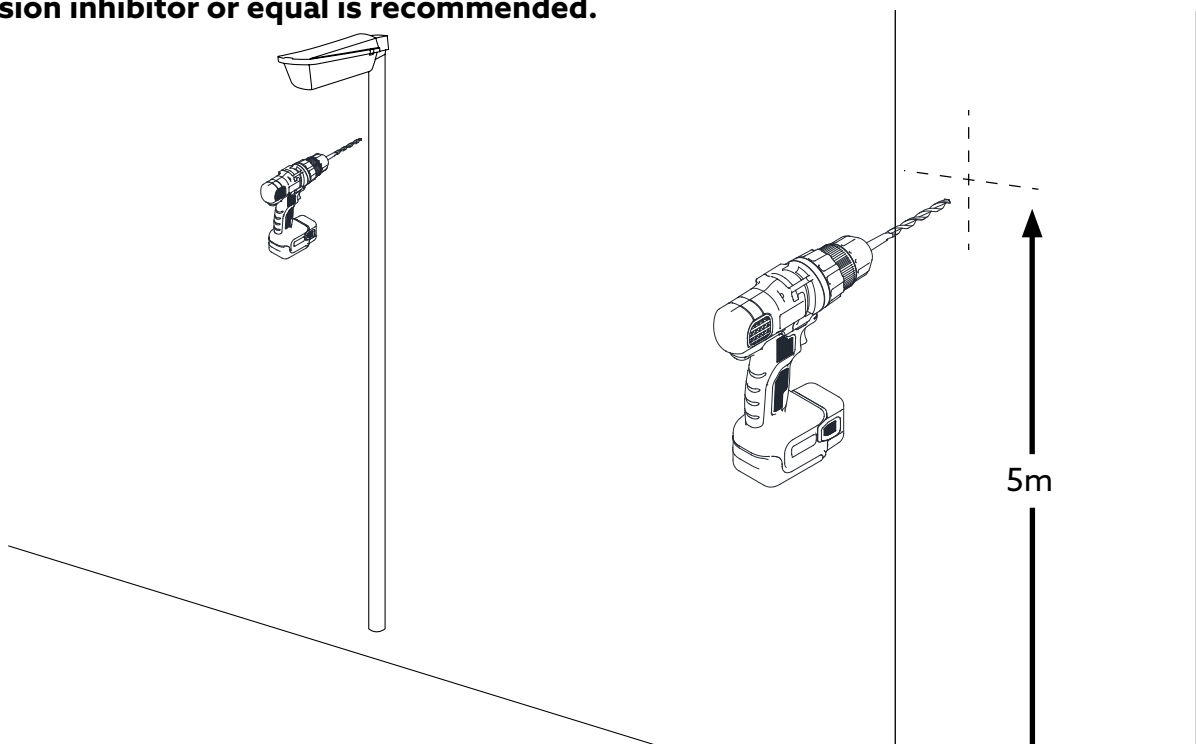

3. Run wire through hole in the pole

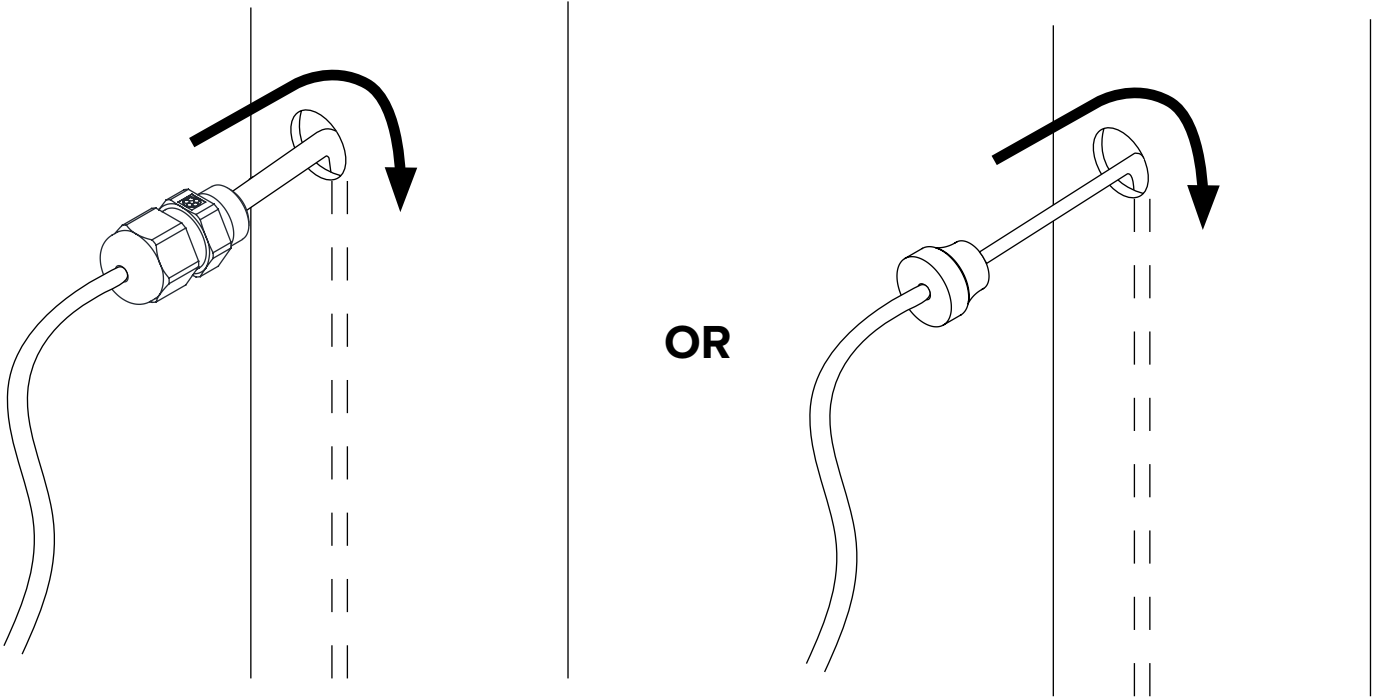

4. Insert Cable Gland/Grommet into hole in the pole

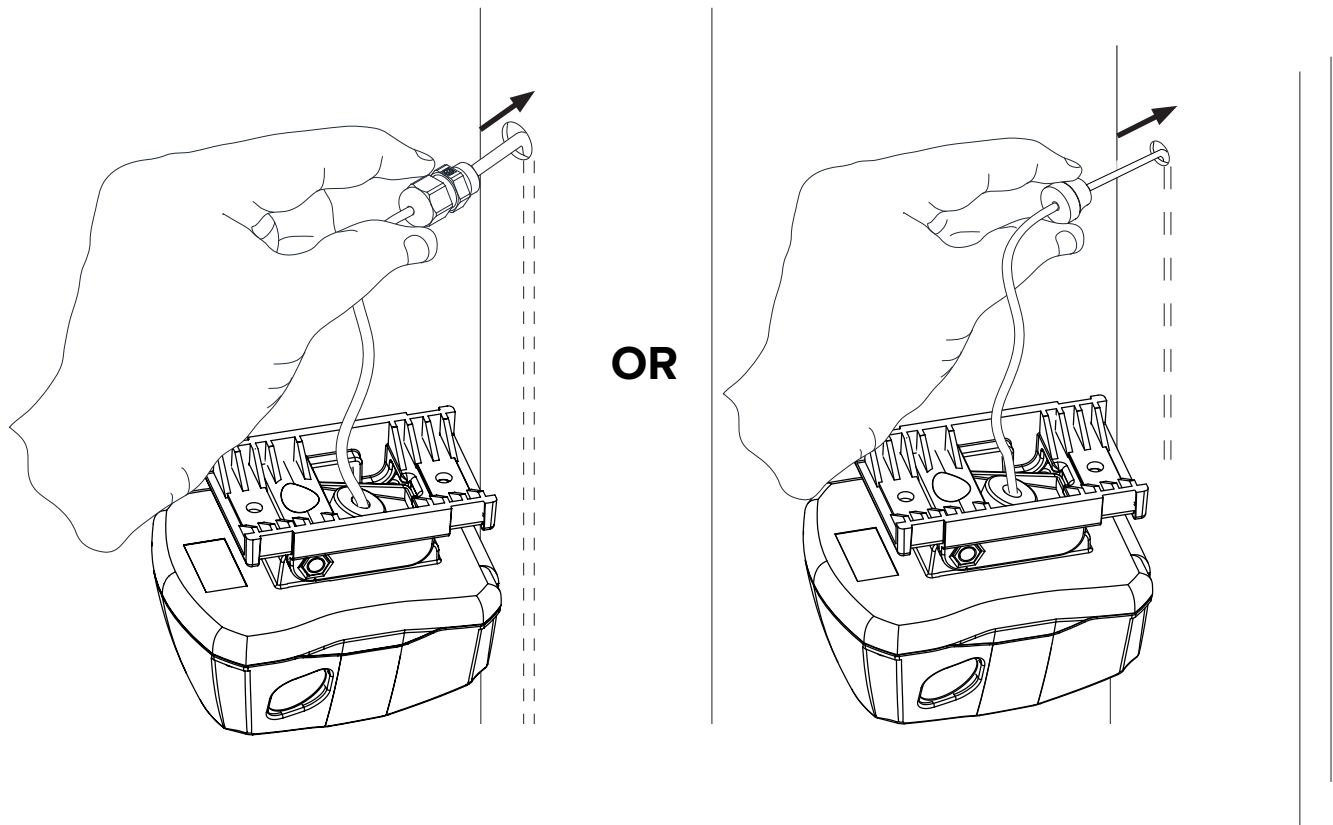

5. Screw Cable Gland OR press Grommet into the pole

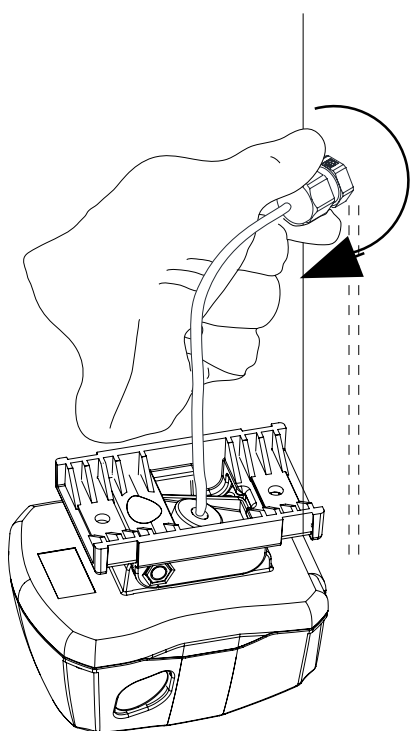

OR

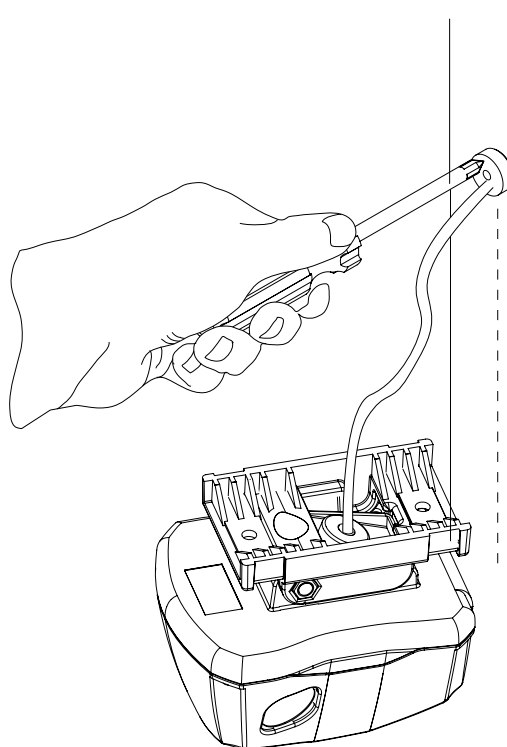

6. Strap product to the pole

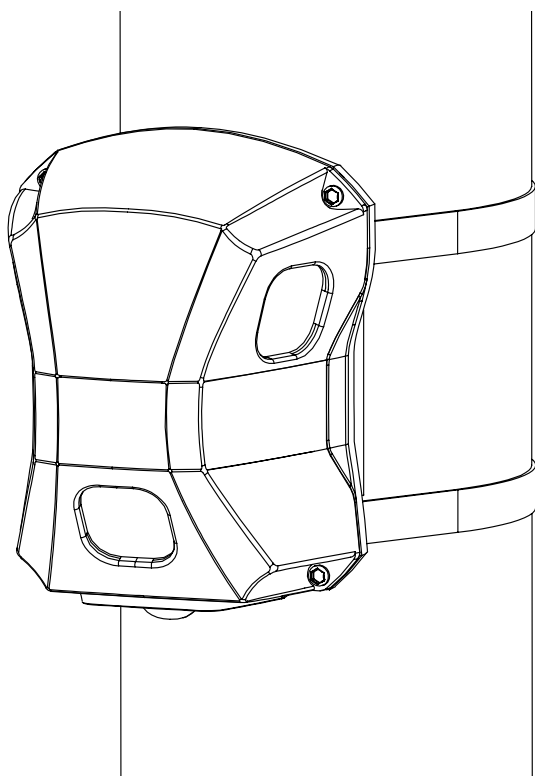

Tensioning Tool

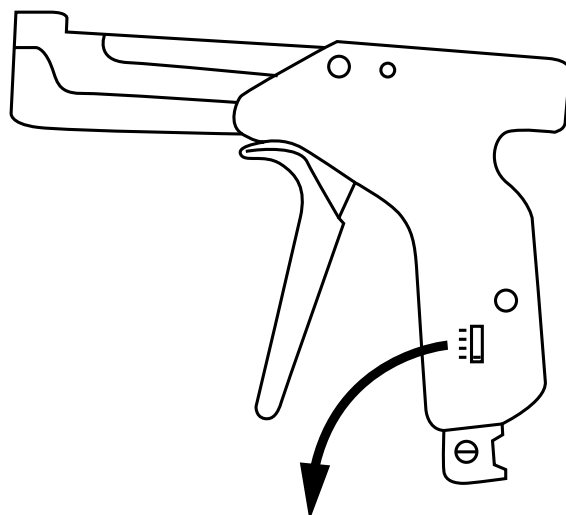

* Ensure Tensioning Tool is set to maximum tension (#4)

7. Level the product

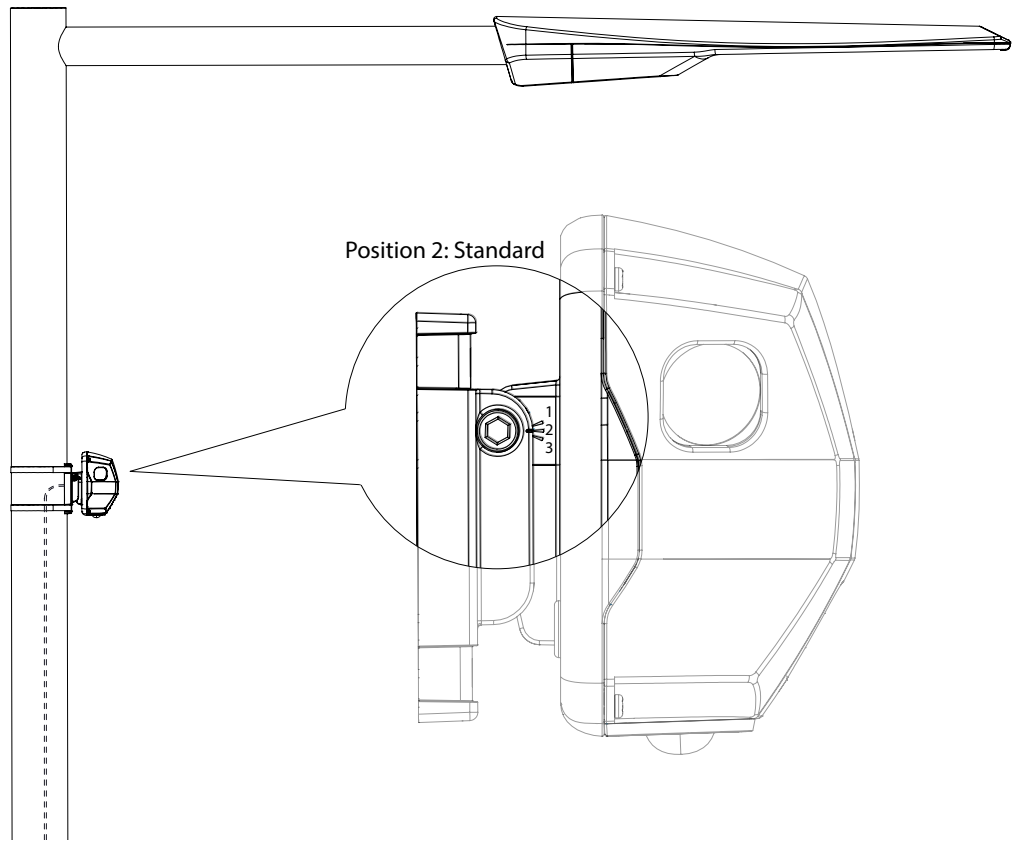

8. Apply product ID sticker to pole

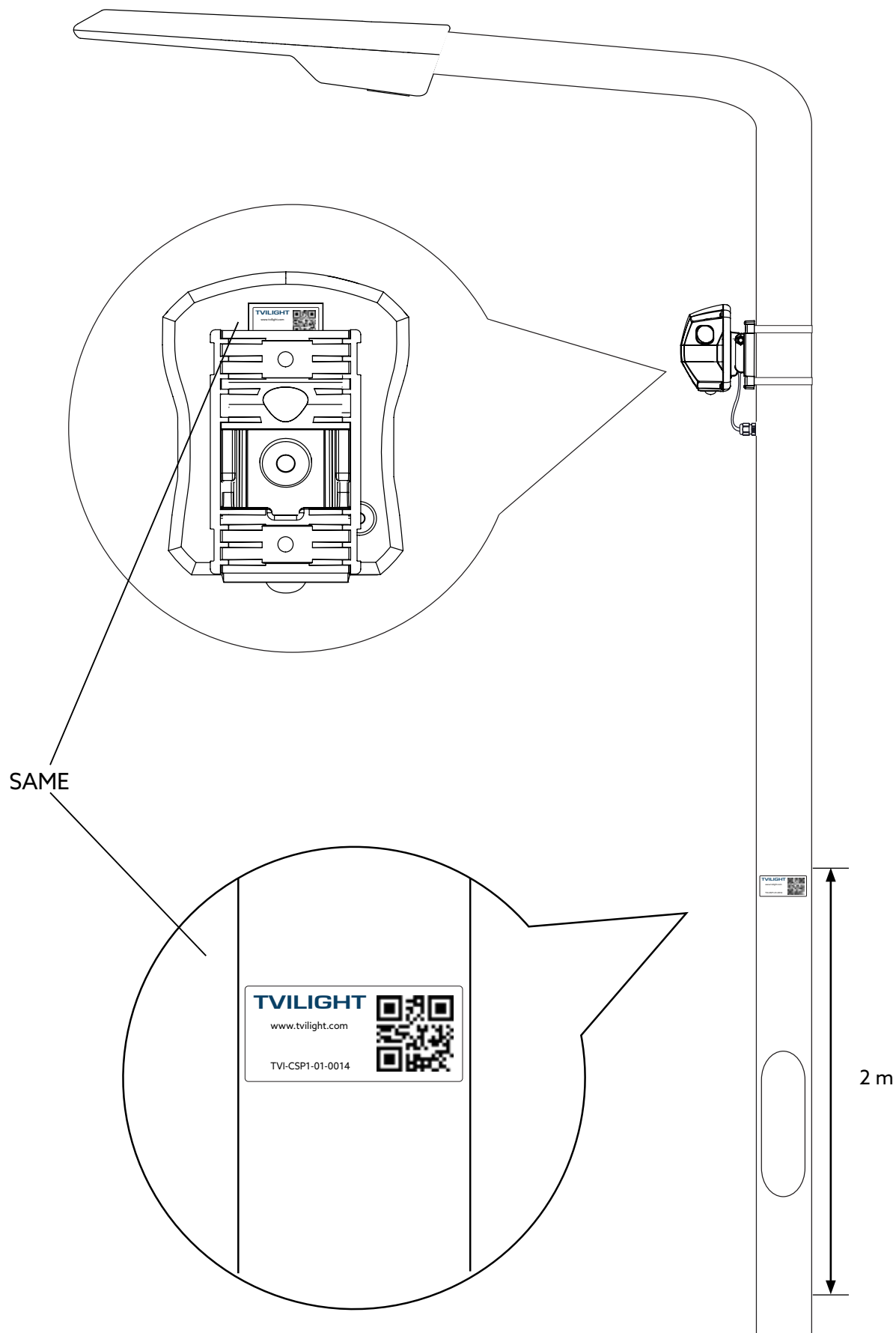

9. Add device to CityManager

1. Download Tvilight Scan&Go from Apple iOS App Store or from Google Play Store.
2. Login with your Username and Password.
3. Use the 'Add device' function in Scan&Go app to add the device to CityManager.
4. The location of the new device is determined by Scan&Go's GPS and it will be indicated on the map.
5. The Device Serial Number will be added when scanning the QR-Code with the camera.
6. Fill in the required fields (the ones with an asterisk), select the device type and also **select the type of ballast** (PWM or DALI-Logarithmic or DALI-Linear).

Note: The type of ballast must be known before installation.

7. Press save and move to next device.

For more information on how to use Scan&Go app, please visit:
<https://www.tvilight.com/scan-go/>



Wiring Diagram

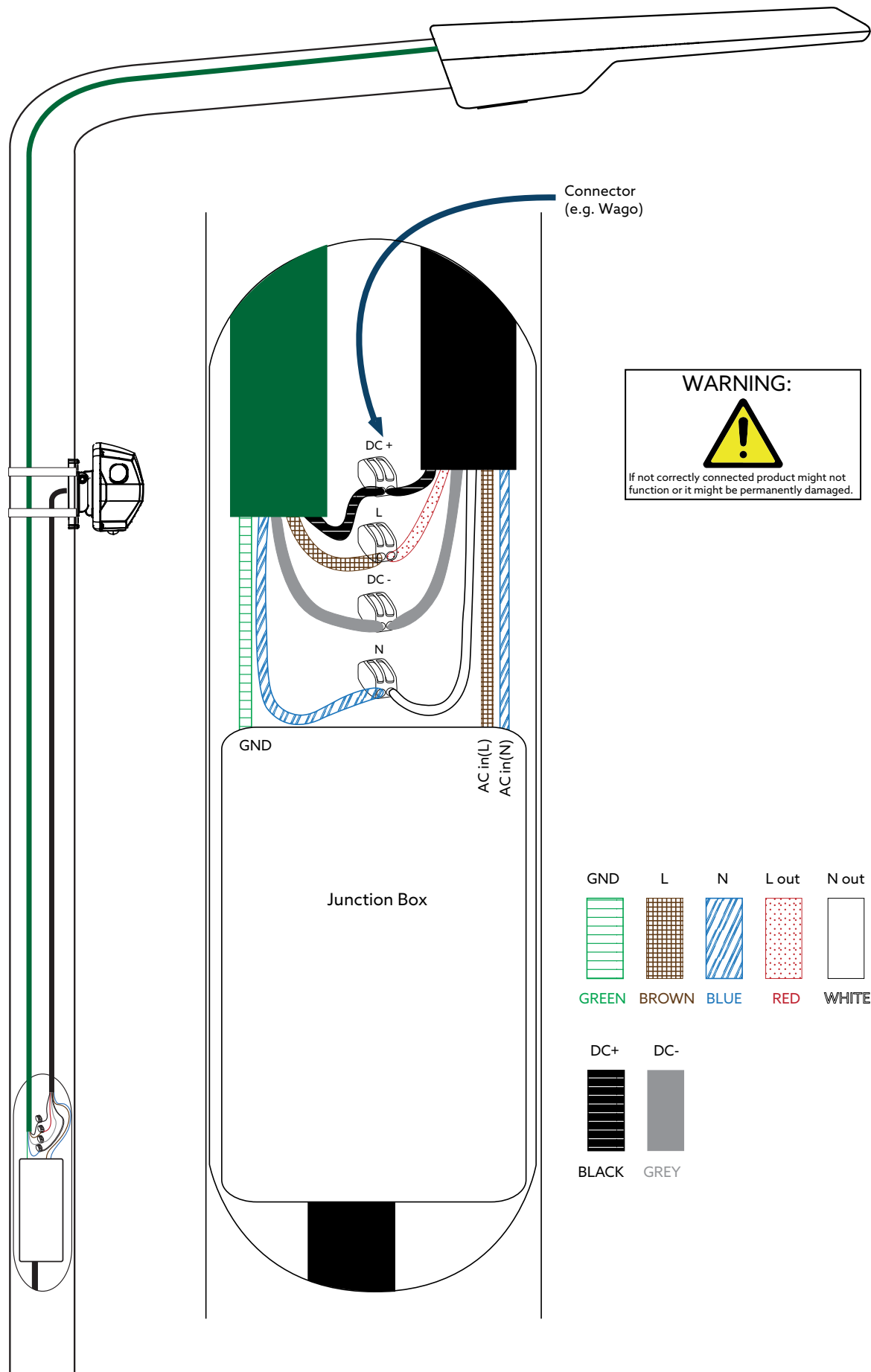

Wiring Diagram

For Single-Arm Luminaire

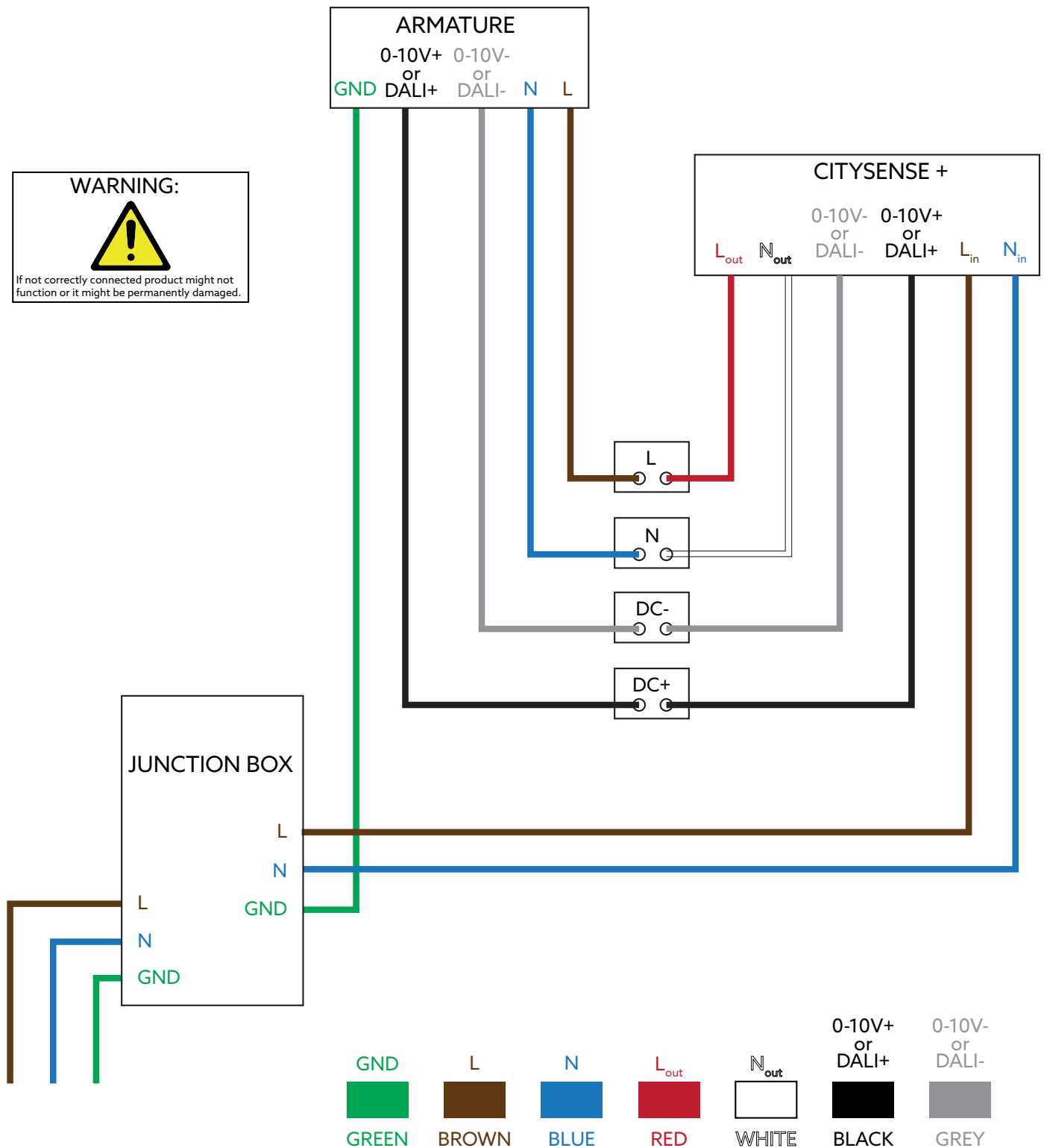

Note:

For added protection, an external circuit breaker and overvoltage protector at the power input of the product are mandatory. Circuit breakers such as the ELeQ LS-94 5L2408 or similar rated products are acceptable. Overvoltage protectors such as Tvilight Overvoltage Protector is acceptable.

Wiring Diagram

For Dual-Arm Luminaire

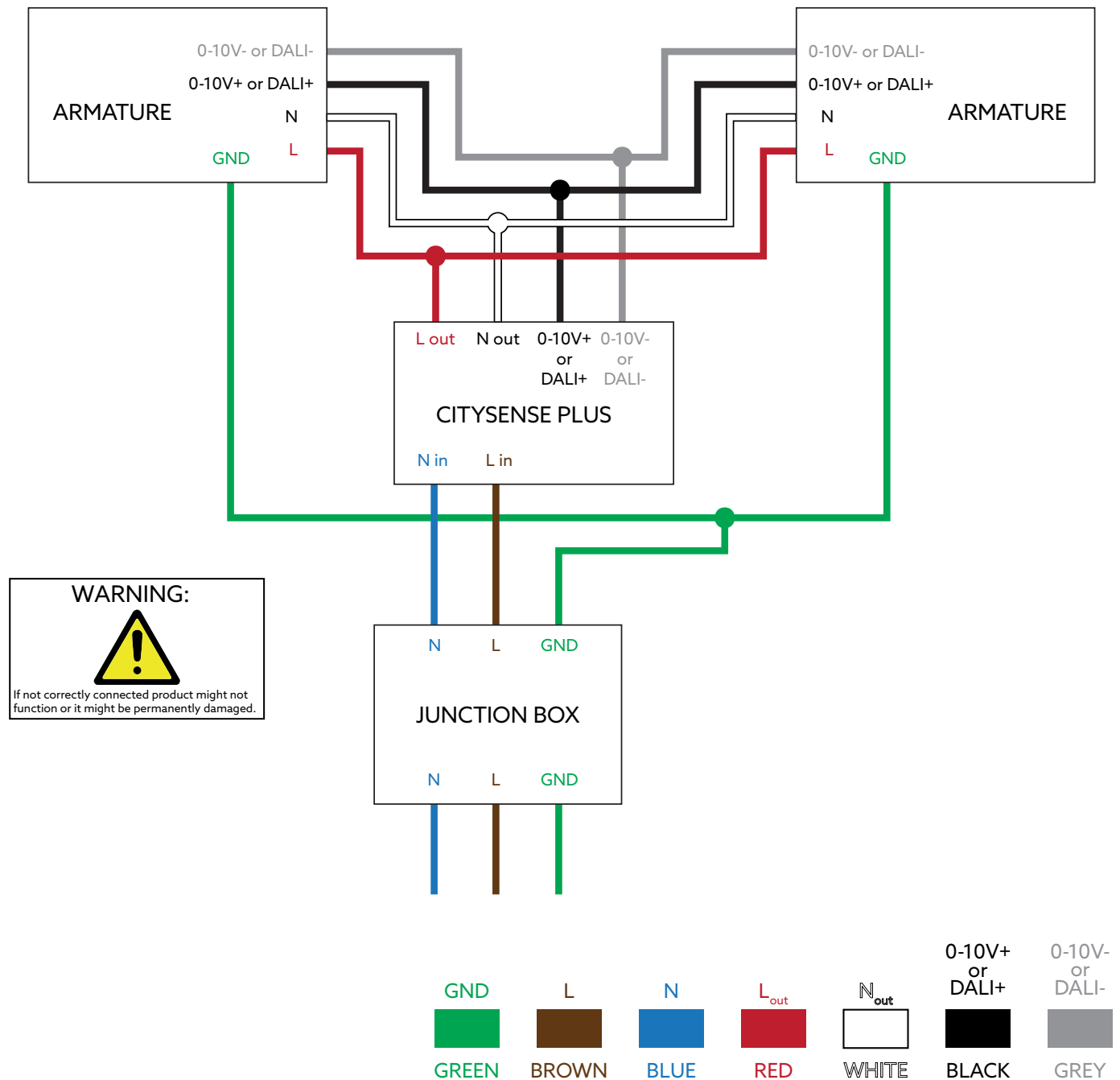

Note:

1. For added protection, an external circuit breaker and overvoltage protector at the power input of the product are mandatory. Circuit breakers such as the ELeQ LS-94 5L2408 or similar rated products are acceptable. Overvoltage protectors such as Twilight Overvoltage Protector is acceptable.

2. When using CitySense+ for controlling more than one streetlight fixture, please ensure that all the connected Drivers are in the same dimming mode (either 0-10V or DALI).