

ACU Z18 Set

Zhaga book 18 Ed. 2 receptacle

Product description

- Set consisting of receptacle, lock washer and mounting nut (ACU Z18 REP 4PIN)
- Designed for street lighting control
- Compliant with Zhaga book 18 Ed. 2
- Optional IP66 with sealing cap (ACU Z18 CAP IP66)
- UL UV-f1 rated for outdoor use
- IK09 high impact resistant

Housing properties

- Casing receptacle: PBT
- Type of protection IP20

Interfaces

- Supplies Zhaga book 18 Ed. 2 contact system



Standards, page 3



ACU Z18 REP 4PIN + ACU Z18 CAP IP66



ACU Z18 REP 4PIN + ACU Z18 CAP IP66



ACU Z18 Set
Zhaga book 18 Ed. 2 receptacle

Technical data	
Voltage AC/DC	30 V
Mains frequency	50 / 60 Hz
Max. rated current	1.5 A
Mounting hole	acc. to Zhaga book 18 Ed. 2
Type of installation	Zhaga book 18 Ed. 2 socket
Ambient temperature ta	-40 ... +90 °C
Dimensions Ø x H	ø36.5 x 27.4 mm
Housing material receptacle	PBT
UV resistance	f1
Type of protection ^①	IP20
Impact protection rating	≤ IK09

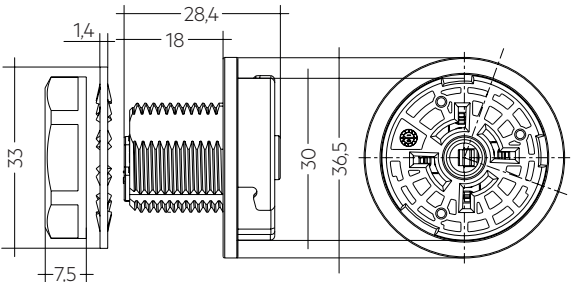

ACU Z18 REP 4PIN

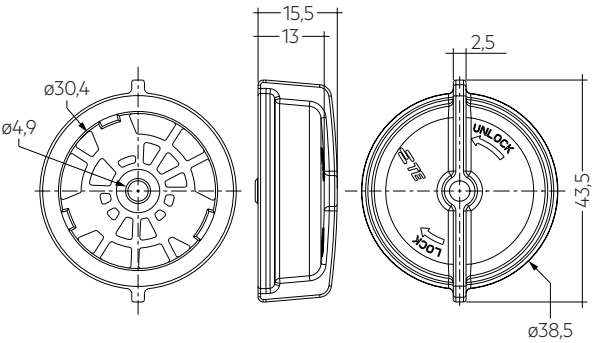

ACU Z18 CAP IP66

Ordering data			
Type	Article number	Packaging bag	Weight per pc.
ACU Z18 REP 4PIN	28003209	100 pc(s).	0.008 kg
ACU Z18 CAP IP66	28003208	100 pc(s).	0.020 kg

① With attached ACU Z18 CAP IP66 will be achieved.

1. Standards

UL 94V-0
 UL UV-f1
 UL 94V-2 (locking nut)
 EN 61984:2009

2. Common

This connector system is typically used in street light applications, as well as area lighting and IoT network applications.

The receptacle is supplied with a 4 position contact system. All contacts are being pre-installed in the receptacle.

The receptacle contacts are wire poke-in style termination contacts.

The cap is not supplied with the base assembly, but available separately (ACU Z18 CAP IP66, article number: 28003208).

It is the responsibility of the customer to provide and install the light or sensor control electronics.

3. Installation

3.1 Receptacle (ACU Z18 REP 4PIN):

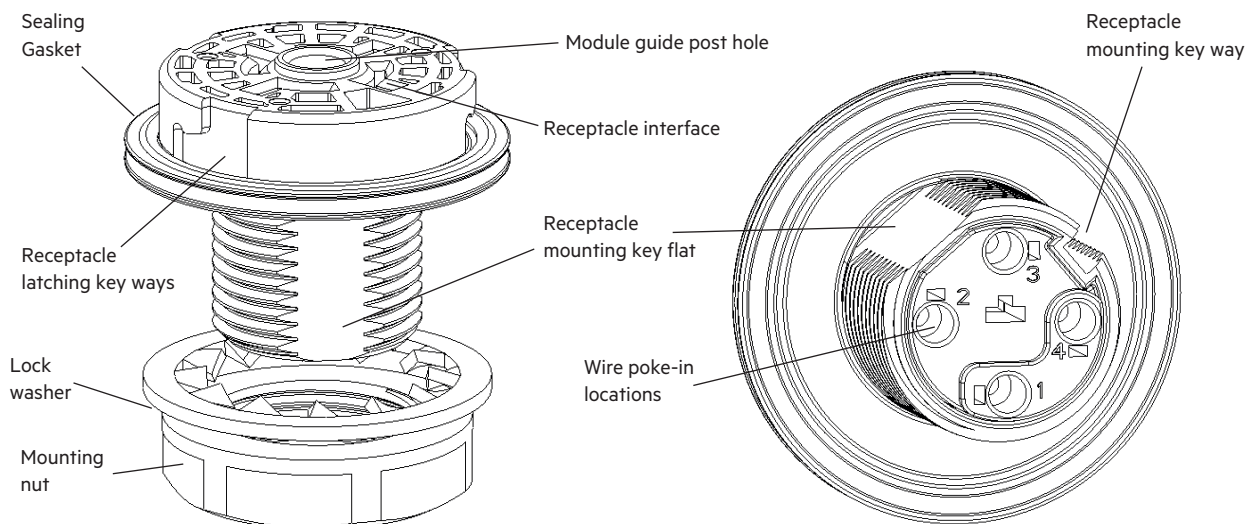

3.2 Cap (ACU Z18 CAP IP66):

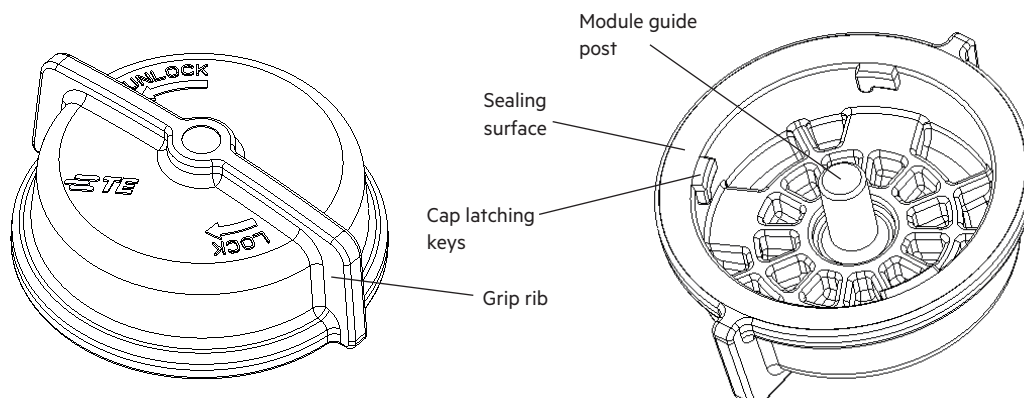

3.3 Receptacle mounting (ACU Z18 REP 4PIN):

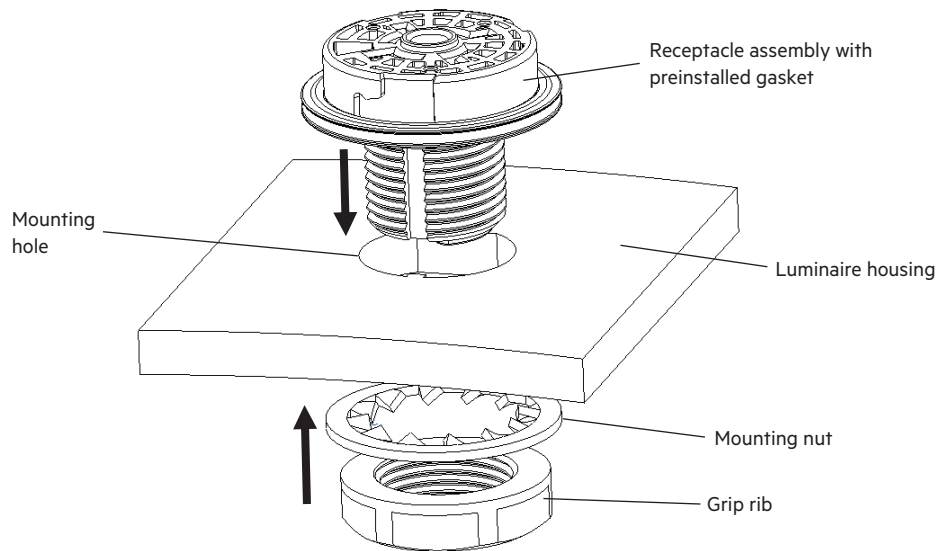

3.4 Mounting hole (ACU Z18 REP 4PIN):

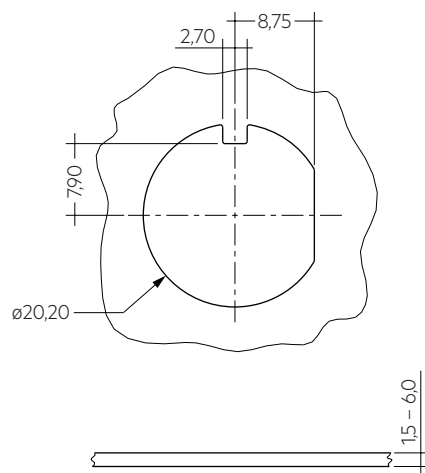

Zhaga book 18 Ed. 2 axis description:

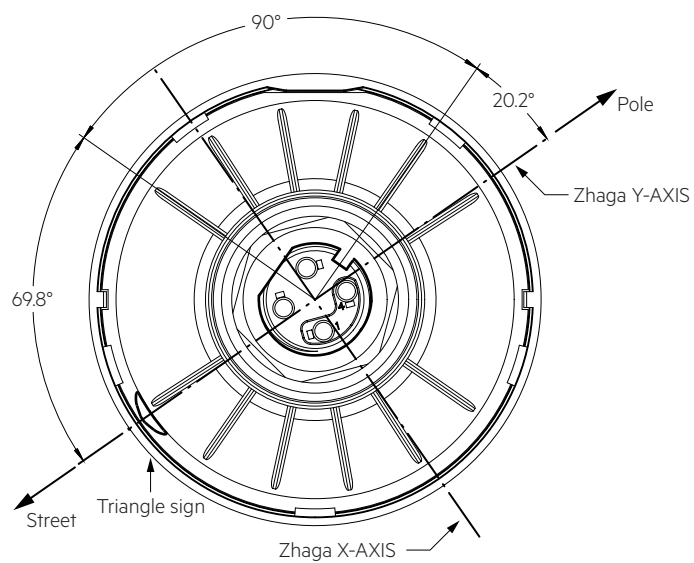

3.5 Lighting fixture with ACU Z18 REP 4PIN connector:

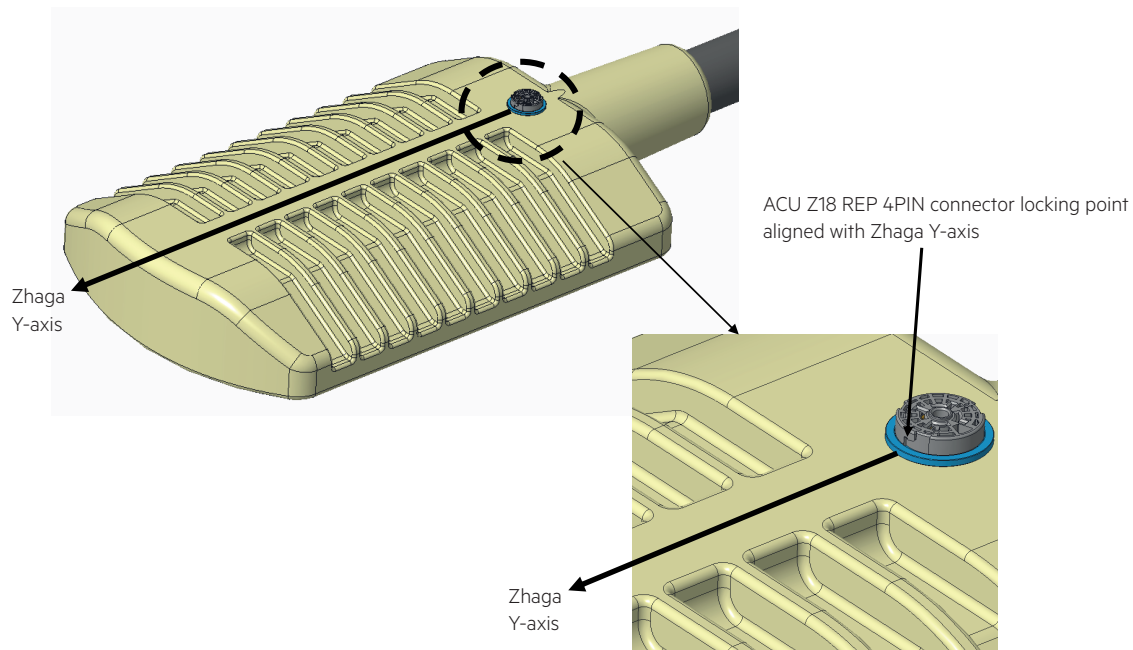

3.6 Wire connection receptacle:

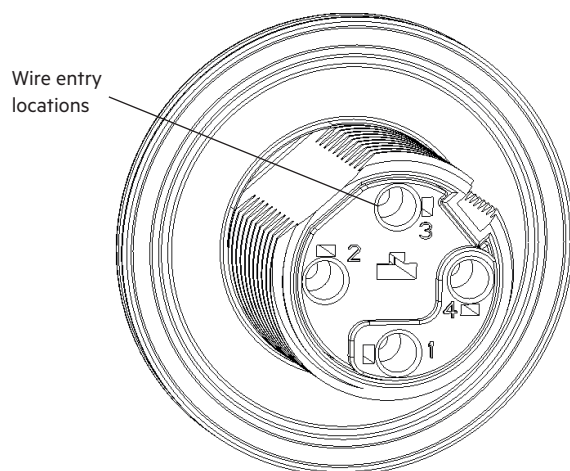

Pin number	Function
1	+24 V power supply
2	Negative pole for DALI / shared ground for 24 V power supply
3	Positive pole for DALI
4	Not connected this refers to Zhaga book 18 Ed. 2 standard

3.7 Wire type and cross section:

The receptacle assembly will accept 16 – 20 AWG solid and 18 – 20 AWG stranded tin-dipped copper wire only. The table in Figure below provides wire selection for the poke-in connectors.

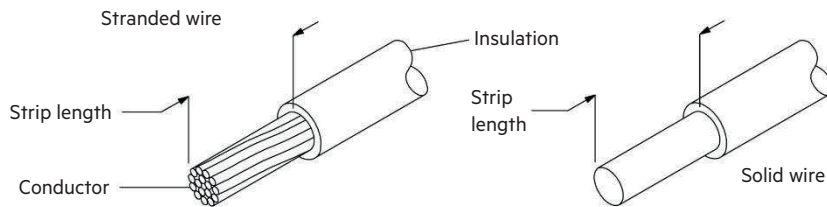

Recommended wire			
Wire size	Wire type	Insulation diameter	Strip length
16 AWG	Solid	\varnothing 2.95 max. \varnothing 1.90 min.	11.0 \pm 1.0
18 AWG	Solid		
	Stranded (tin-dipped)		
20 AWG	Solid		
	Stranded (tin-dipped)		

3.8 Wire release:

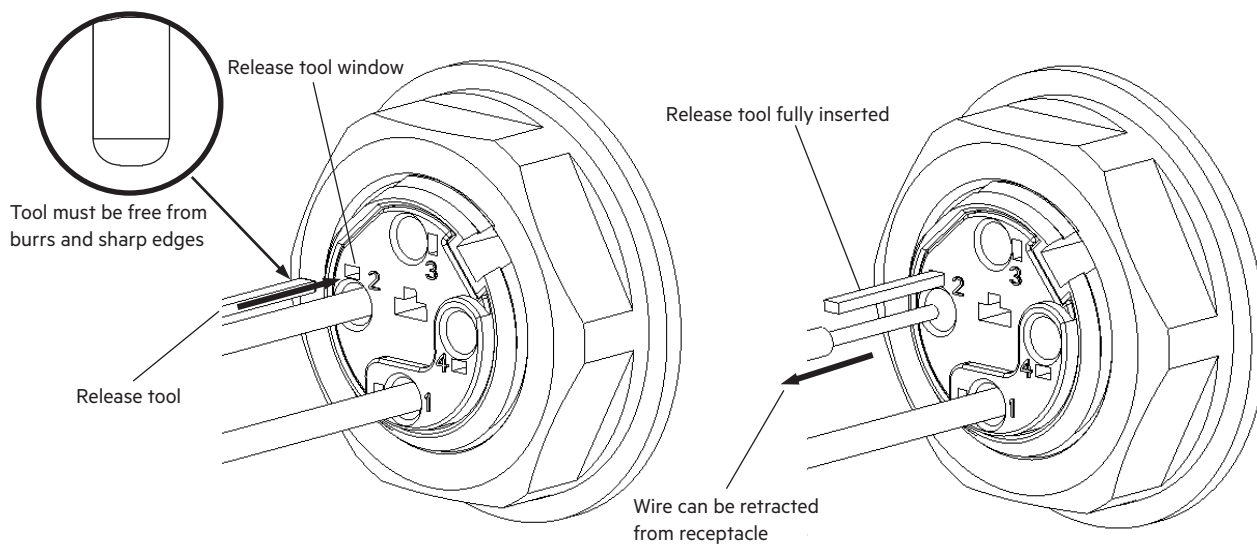

3.9 Cap release (ACU Z18 CAP IP66):

Align the sealing cap over the mounted receptacle. Based on polarizing features on each, the sealing cap can only be installed in one position.

Lightly rotate the sealing cap until you feel the alignment keys and the blades align to the proper location. After alignment, push downward until the sealing cap is bottomed on the receptacles mating face.

Then complete mating by rotating sealing cap with downward pressure while twisting in a clockwise direction. The sealing cap will lock into position with an audible 'click'.

To un-mate, gently push down and reverse the process.

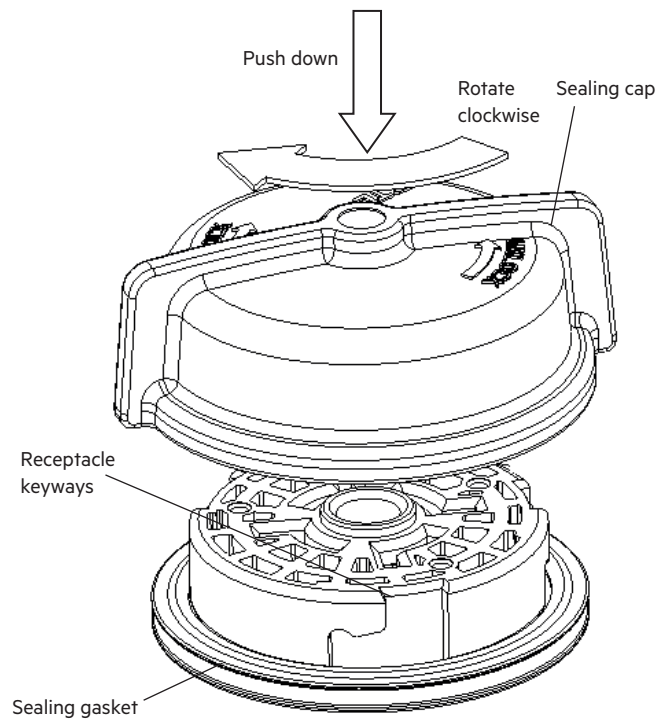

4. Miscellaneous

4.1 Additional information

Additional technical information at www.tridonic.com → Technical Data

Guarantee conditions at www.tridonic.com → Services

Life-time declarations are informative and represent no warranty claim.

No warranty if device was opened.