

Tvilight Nema 7-pin receptacle provides a mechanical and electrical interconnection between an ANSI C136.41 compliant outdoor lamp controller and street luminaire. Ideal for public lighting, the Nema 7-pin socket is available with four dimming contacts to support either 0-10 VDC analog dimming or DALI (Digital Addressable Lighting Interface) dimming as well as possible connection of motion sensor. Nema socket is constructed of durable long-life material. It comes with silicon gasket to maintain water tightness and IP rating of the smart street light fixture.



Features

- Fixed (non-rotatable) mounting for robust mechanical connection
- Pre-terminated wire leads for ease of integration into new or existing light fixtures
- Supports ANSI standard based 3-pin, 5-pin and 7-pin shorting cap, dimmable photocell, and smart lamp controller
- Reliable twist-lock contacts for a reliable power interconnect
- High temperature (105°C) rated wire insulation for protection against high internal luminaire temperature
- Available with four dimming contacts to support dimming as well as sensor connectivity

Electrical

cUL Recognized Component

Power contacts	Voltage rating: max. 480 VAC / DC Current rating: max. 15 A
Dimming contacts	Voltage rating: max. 30 VAC / DC Current rating: typical 250 mA (rated 1.5A)

Mechanical

Confirms to ANSI C136.41 – 2013 Standard

Number of cables	3 wires for AC Mains Contact (14 AWG) 4 wires for Dimming / Signals (18 AWG)
Wire length	30 cm (approx. 12")

Contacts of Power Cables terminated as per UL1015

Contacts of Dimming Wires terminated as per UL1015

Materials

Power contacts	Phosphor copper
Dimming contacts	Phosphor copper with nickel plating. Gold plating on the contacting parts
Housing	Bakelite

Operating Temperature

Ambient temperature	-40°C to +70°C
---------------------	----------------

Certificates and Standards

Ingress protection class	IP66 when combined with suitable Shorting Cap, Photocell or Smart Lamp Controller
Approved marks	UL listed CE and CB certified RoHS and REACH Compliant

Dimensions

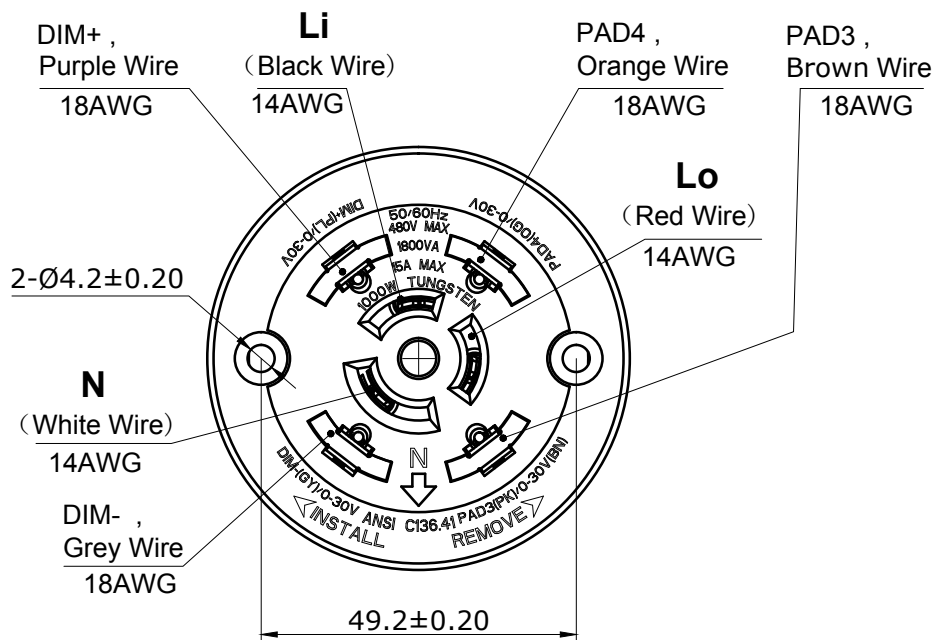
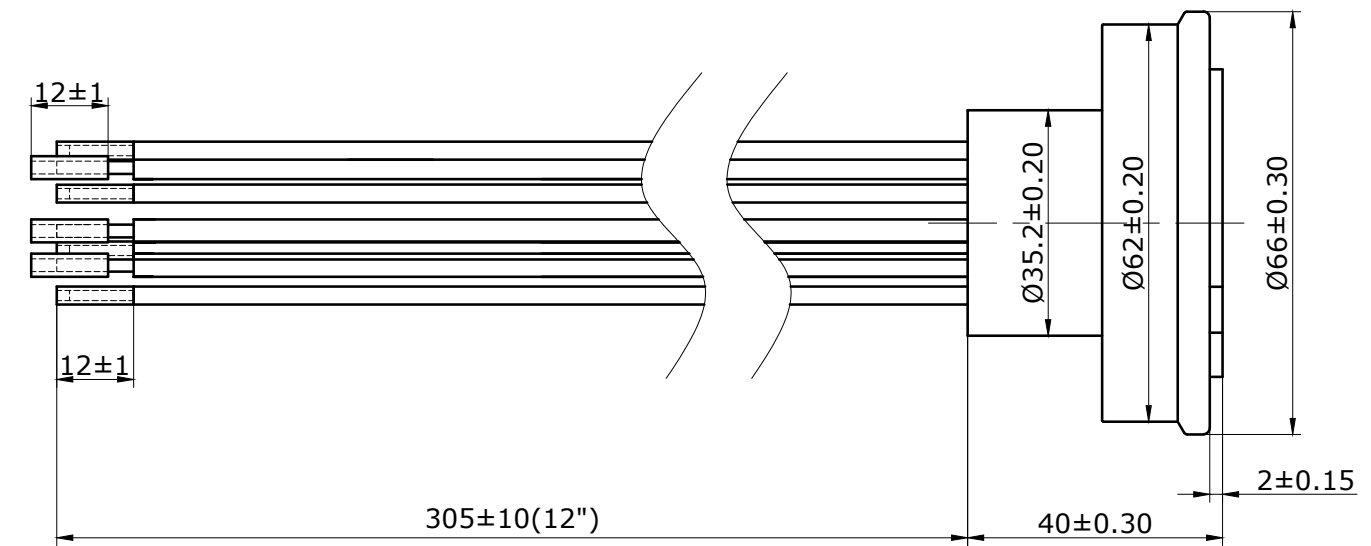

Packaging

Item	Dimension	Quantity
Molded Pulp Tray	/	20 units
Master Carton	41 x 33 x 35.5 cm	100 units

Wiring Diagram

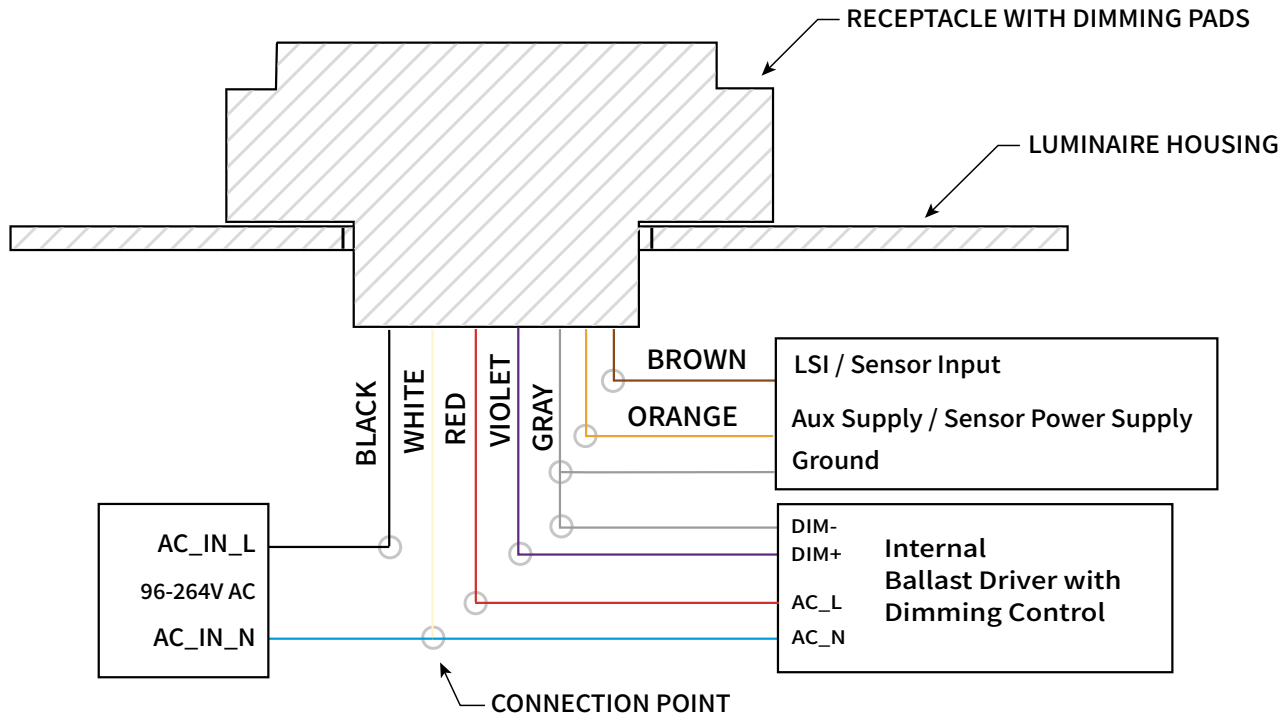

Compatible Parts

OpenSky NEMA IoT	NEMA 7-pin Outdoor Lamp Controller with Cellular IoT connectivity and on-board GPS
SkySwitch NEMA	NEMA 3-pin Photocell IP67 with filtered photodiode

Applications



Street and Roadway Lighting



Commercial Lighting

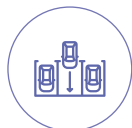

Outdoor Parking Lots



Sports Lighting



Ports/Harbors /Shipyards



Campus Street Lights